

SAIL YACHT

X Yachts 19m

X6<sup>5</sup>

Photos: Giorgio Baroni | Words: Janine Devine





Living in a world of superyachts here at NAVIS, it is often too easy to focus solely on size. The latest technology, quality finishes, exceptional design, and peak performance come in all dimensions and can be found even in production models. Nowhere is this manifested so exceptionally as in X Yachts' X6<sup>s</sup>, the prototype for their luxury PURE X range which originally debuted in 2017 to fully embrace the brand's ethos of 'Superior Sailing Pleasure.' This line has continued to evolve because of X Yachts' ongoing commitment to innovation as well as solicitation of -- and responsiveness to -- owner feedback.

All the awards and recognition achieved since X Yachts' founding 41 years ago in Haderslev, Denmark are in evidence here: at 19m/63 feet, the X6<sup>s</sup> model is the idealization of the marriage of cruising and racing boats. With an abundance of standard features that take her well into the performance category as well as an extensive range of options to please the most discerning cruiser, the X6<sup>s</sup> is an all-around winner.

One can easily visualize taking her out on your own after handover for a sunny late summer afternoon around Bornholm with just the kids or a few friends. Or, closer to one's home port perhaps, running her down to say, Abaco, or taking on the '1500' with minimal crew. She's a pleasure to sail, even for the novice. And, at the risk of sounding like a water park advertisement, this makes the X6<sup>s</sup> fun -- and safe -- for the whole family.

But that's not to imply that the X6<sup>s</sup> isn't sexy. She will definitely turn heads, even in harbors that are home to competing shipbuilders. And no wonder, her sleek, bold lines command attention. Topside, halyards and lines have been diverted to the aft coamings, so as to enhance guest comfort and enjoyment and preserve the deck-scape of exquisitely finished quarter-sawn teak. They reappear later aside steering pedestal-adjacent units which house the electric Harken winches as well as the electric deck furlers, easily deployed by their respective switches on the console. In fact, double- or short-handed sailing are both a breeze here and under a variety of conditions, which points again to purposeful design. In the cockpit, a table with adjustable legs which adjusts to coffee-table height or lowers to create an ideal sunning area, with space for an optional mini-fridge if needed, enhance guest experience so hosts are happy. But the sheer variety of custom options that abound here -- including V-shaped furlers from FurlerBoom with even more options for greater sailing speed -- will thrill those more focused on performance.















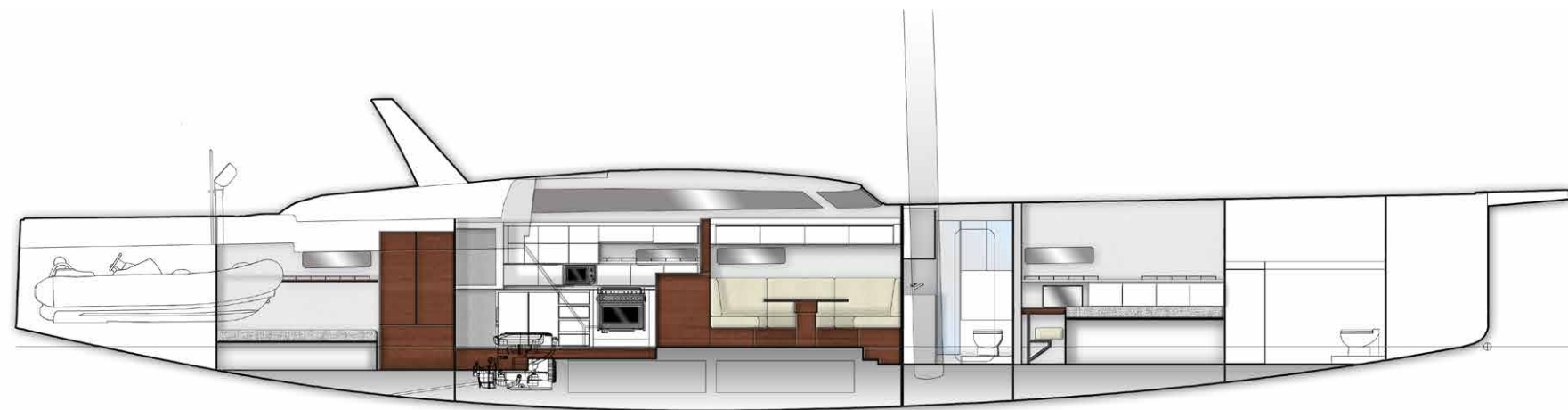

Power is provided by a 119kw/160 HP Yanmar engine, which is standard. X Yachts has long enjoyed the reliability and performance of this brand and has continued this trusted relationship in the PURE X line. It makes a difference here since Yanmar's reputation is built on its power and reliability, which is a complement to typical Danish values, X Yachts' included. Although the PURE X range wasn't intentionally designed for racing doesn't mean it can't outrace challenging weather conditions where many other boats may fail.

Below deck, the overall attention to the interiors best exemplifies what is iconic and best-loved about Danish design: sleek lines and supreme livability with thoughtful maximization of space. Spacious interiors are key to keeping all members of the family happy. Panoramic windows and hull portlights beckon daylight in and expand the outdoor living lifestyle that is so appealing. Small details really do make a difference, and they are here: a spacious and well-designed galley featuring brushed stainless or corian counters with integrated sinks, sleek recessed shelving along the bulkheads with trim gallery shelves accommodate a variety of essentials, memorabilia, or décor. In the owner's cabin (which itself has 3 layout options), along with easy-to-reach storage space under the berth, space has been optimized with double wardrobe, sofa with underneath storage, and even more recessed shelving. More integrated corian sinks and counters are in all the heads, along with standard Tecma electric toilets

But ultimately, what lies beneath is at the core of X Yachts lineage: hull design with optimum weight concentration. By taking weight out of the boat and keeping it low into the keel with the deeper, reinforced hull the design adds greater stability and maximum strength at sea. Retractable bow thruster comes standard, with retractable stern thruster an option. Beyond this standard galvanized steel-girdered hull construction, X Yachts is happy to customize this model for maximum appeal in a myriad of ways.

X Yachts' engineers have produced an uncompromisingly successful design in the X6<sup>s</sup>. She works as well at sea or in harbor, sails beautifully, accelerates better, and since lifestyle is just as important as handling, will entice both racing and cruising enthusiasts alike. ⊕



